

Bus Disaster

The following procedures are for use by bus drivers and appropriate school administrators in the event of an earthquake, serious bus accident, or other emergency that occurs while students are on a field trip or being transported to or from school. This section addresses two possible scenarios involving a bus disaster: (1) an earthquake and (2) a serious accident or bus fire. It is important to note that drivers may need to make spontaneous, independent decisions based on the nature of the emergency, age of the children, location of the bus, and other unique circumstances to ensure children's safety.

Scenario 1 – Earthquake

- 1) Upon first indication of an earthquake, the bus driver should issue Drop, Cover, and Hold procedures to all students on the bus.
- 2) The bus should be moved away from all power lines, bridges, overpasses, possible landslide conditions, overhanging trees, or other dangerous situations.
- 3) The bus driver should set the emergency brake, turn off the ignition, and wait for the shaking to stop.
- 4) The bus driver should check students for any injuries and provide first aid, as appropriate.
- 5) In the event the bus is disabled, the driver and students should stay in place until help arrives.
- 6) The bus driver should contact the School Administrator and the District Transportation Director to report on the location and condition of students on the bus.
- 7) The School Administrator will determine what additional appropriate notifications should be made and will brief the District Superintendent on the situation.
- 8) If the bus driver is instructed to resume the bus route, the driver should continue to pick students up. Students should only be dropped off if a responsible adult is at the bus stop.
- 9) If it is impossible to return to school, the bus driver should contact the School Administrator and remain with the children until further instructions are received.
- 10) The bus driver is responsible for all students who board the bus throughout the emergency.

Scenario 2 – Serious Accident or Bus Fire

- 1) The bus driver will park the bus in a safe location with the emergency brake set and the ignition off.
- 2) In the event of a fire, students and the driver should evacuate the bus immediately and move to a safe location away from the bus and traffic using available barricades (e.g., trees, cars) when available.
- 3) The bus driver will immediately call 911 and provide the exact location of the bus and wait for the arrival of emergency response personnel.
- 4) The bus driver should check students for injuries and provide appropriate first aid.
- 5) The bus driver should call the School Administrator and the District Transportation Director (refer to the Essential Contacts in the Appendices of this Plan) to report the location and condition of students.
- 6) The School Administrator will determine what additional appropriate notifications should be made and will brief the District Superintendent on the situation.
- 7) The bus driver is responsible for accounting for all students throughout the emergency.

Earthquake

A. INSIDE SCHOOL BUILDING:

- 1) The teacher, or staff member in authority, will implement the action, "DUCK, COVER AND HOLD." Stay inside the building until the shaking stops.
- 2) Try to avoid glass and falling objects, areas where there are large panels of glass and/or heavy suspended light fixtures.
- 3) Do not use telephones.
- 4) Implement action, "LEAVE BUILDING." Over intercom, when instructed to do so, after the earthquake is over and tremors have subsided. Special consideration should be given to exit routes as some exits have heavy roof structures over the doorways. Go to an open area away from trees, power poles, etc.
- 5) Avoid touching electrical wires and metal objects such as chain link fences.
- 6) Render first aid if necessary.
- 7) Take roll and report results to the Principal/Incident Commander.
- 8) Activate a buddy system and determine the needs of neighboring classrooms. Listen for directions.
- 9) Principal/Incident Commander to request assistance through school district channels. Notify the District Emergency Operations Center of any breaks in utility lines.
- 10) The Superintendent/Designee will determine the feasibility of closing the school, based on the report of the Principal/Incident Command

B. IF OUTSIDE SCHOOL BUILDINGS:

- 1) Move away from buildings, playground equipment, utility poles, signs, trees, metal fences, exposed wires, and wet areas.
- 2) The safest place is in the open. Stay there until the earthquake is over.
- 3) DO NOT RUN! "DROP AND TAKE COVER!"
- 4) Follow procedures 3 through 10 under "Inside School Building."

Explosion or Risk of Explosion

- 1) DUCK, COVER, AND HOLD commands are to be given immediately. Do not approach windows or doors.
- 2) If the explosion is not in the building, students and staff are to remain at their assigned locations until directed by Principal/Incident Commander
- 3) When directed, evacuate.
- 4) If necessary, move to safe assembly areas outside the building and away from the location of the explosion.
- 5) Render first aid as necessary.
- 6) Take roll and report results to the Principal/Incident Commander.
- 7) If possible, fight small fires without endangering life.

Fire in Surrounding Area

- 1) Sound the school alarm and evacuate the building.
- 2) Notify the office and Principal/Incident Commander.
- 3) Assemble at the pre-designated area (refer to evacuation map).
- 4) Assist disabled during the evacuation.
- 5) Render first aid as necessary.
- 6) Check all bathrooms and ancillary rooms for staff and students.
- 7) If it is possible for adults to fight small fires without endangering life and/or causing injury, do so by using the fire extinguisher.
- 8) Close, but do not lock all doors leading to the fire area to isolate the area and prevent the spread of the fire.
- 9) Take roll and report results to the Principal/Incident Commander. No one should leave the area until instructed to do so.
- 10) In the event of a fire near the school, the Principal/Incident Commander shall determine what action is appropriate and notify the Superintendent.

Fire on School Grounds

- 1) Sound the school alarm and evacuate the building.
- 2) Notify the fire department by dialing 911.
- 3) Assemble at the pre-designated areas at a safe distance from the fire/fire-fighting equipment.
- 4) Assist disabled during the evacuation.
- 5) Render first aid as necessary.
- 6) Check all bathrooms and training rooms for staff and students.
- 7) If it is possible for adults to fight small fires without endangering life and/or causing injury, do so.
- 8) Close, but do not lock all doors leading to the fire area to isolate the area and prevent the spread of the fire.
- 9) Keep access roads open for emergency vehicles.
- 10) Take roll and report results to the Principal/Incident Commander. No one should leave the area until instructed to do so.
- 11) Notify the Superintendent/Designee. The principal will recommend to the Superintendent/Designee whether further action such as the EVACUATION OF SCHOOL should be implemented.
- 12) Notify utility companies of a break or suspected break in their lines.
- 13) After a serious fire, Fire Department officials and maintenance personnel should determine whether the building is safe before students and staff return.

Flooding

- 1) Warning of an impending flood would normally be received at the endangered location by telephone from the District Office or from a Civil Agency (police or fire). If access to the Internet is available, the National Weather Service supplies current weather information, including severe weather warnings at <http://www.nwsla.noaa.gov>.
- 2) Communicate with the District Office. The predicted extent of the flood and the amount of time before it arrives will determine the course of action.
- 3) Keep students indoors until they are determined to be safe.
- 4) Move students to pre-designated areas if an evacuation is ordered.
- 5) Take roll and report results to the Principal/Incident Commander
- 6) The Principal/Incident Commander may initiate the following emergency actions:
 - Dismiss school
 - Leave campus and move to a safe place

Motor Vehicle Crash

- 1) Call 911 to report the crash.
- 2) Determine if any staff or students are in immediate danger. If necessary, evacuate to a safe area. All others are to remain at their assigned locations. Render First Aid as necessary. If evacuation is not imminent, students and staff should remain in classrooms or in assigned areas.
- 3) Consult with District Office and Emergency personnel for further direction and coordinate as needed.

Psychological Trauma

Many emergencies may result in psychological trauma for students and school staff. These emergencies may include an act of violence; the death of a student or staff member; an earthquake or other natural disaster; a serious environmental problem; or ethnic and racial tensions. Emergencies may result in the following conditions:

- Temporary disruption of regular school functions and routines
- Significant interference with the ability of students and staff to focus on learning.
- Physical and/or psychological injury to students and staff
- Concentrated attention from the community and news media

As a result, students and staff may exhibit a variety of psychological reactions. Once the physical safety of those involved has been ensured, attention must focus on meeting the emotional and psychological needs of students and staff.

- 1) The School Administrator will contact the District Superintendent to establish a Crisis Intervention Team, which has primary responsibility for providing necessary assistance after all types of crises.
- 2) The Crisis Intervention Team will assess the range of crisis intervention services needed during and following an emergency.
- 3) The Crisis Intervention Team will provide direct intervention services for students and staff.
- 4) The School Administrator, District Superintendent and Crisis Intervention Team will work together to determine when and how school functions should be restored.
- 5) The Crisis Intervention Team should provide ongoing assessment, if needed, as well as follow-up services, as required.

Unlawful Demonstration or Walkout

- 1) The School Administrator will contact the District Superintendent for direction.

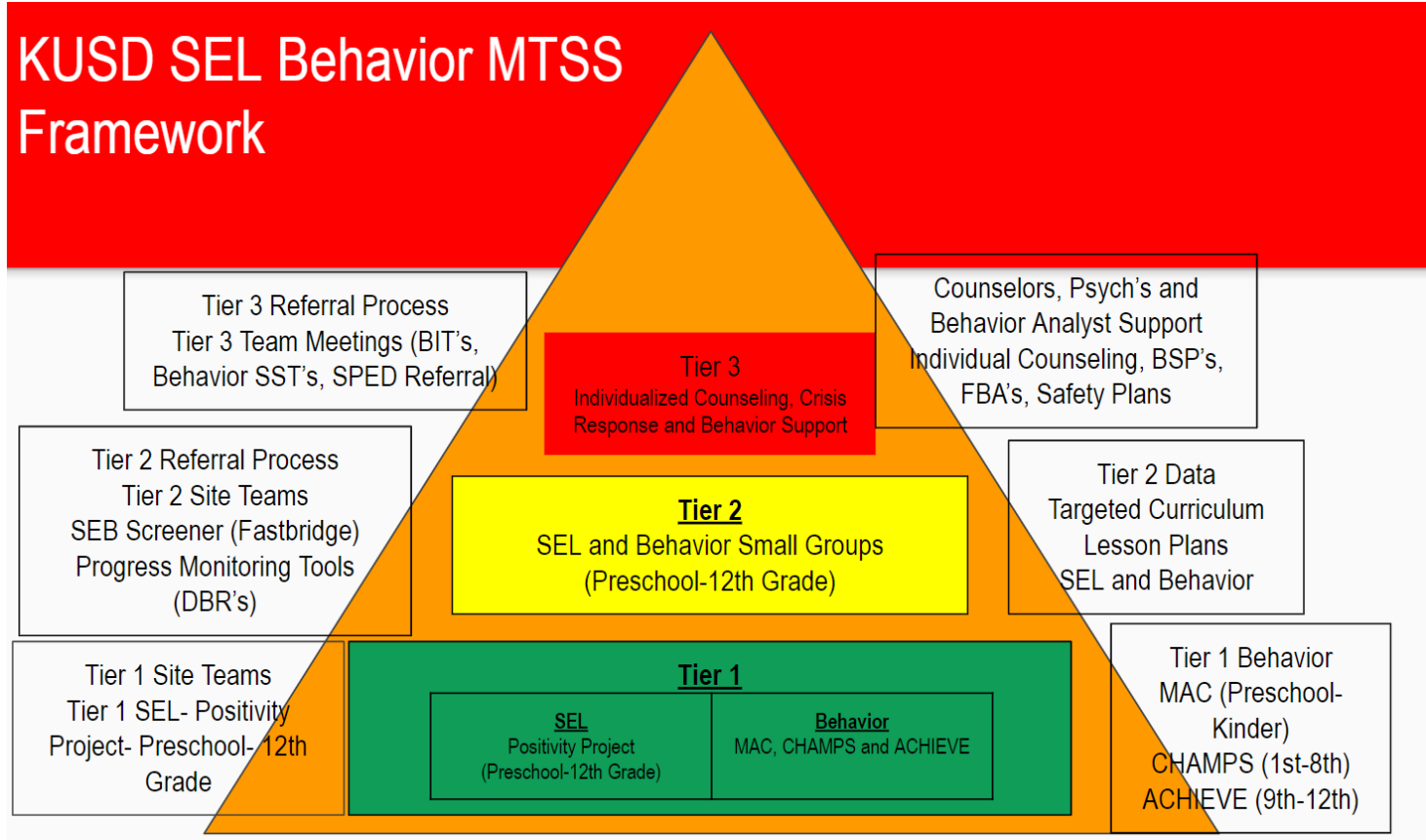

District Board Policies and School Discipline

BP 5144.1

Students

Suspension and Expulsion/Due Process

The Governing Board desires to provide district students access to educational opportunities in an orderly school environment that protects their safety and security, ensures their welfare and well-being, and promotes their learning and development. The Board shall develop rules and regulations setting the standards of behavior expected of district students and the disciplinary processes and procedures for addressing violations of those standards, including suspension and/or expulsion.

(cf. 5131 - Conduct)

(cf. 5131.1 - Bus Conduct)

(cf. 5131.2 - Bullying)

The grounds for suspension and expulsion and the procedures for considering, recommending, and/or implementing suspension and expulsion shall be only those specified in law and the accompanying administrative regulation.

Except when otherwise permitted by law, a student may be suspended or expelled only when his/her behavior is related to a school activity or school attendance occurring within any district school or other school district, regardless of when it occurs, including, but not limited to, the following: (Education Code 48900(s))

1. While on school grounds
2. While going to or coming from school
3. During the lunch period, whether on or off the school campus

(cf. 5112.5 - Open/Closed Campus)

4. During, going to, or coming from a school-sponsored activity

District staff shall enforce the rules concerning suspension and expulsion of students fairly, consistently, equally, and in accordance with the district's nondiscrimination policies.

(cf. 0410 - Nondiscrimination in District Programs and Activities)

Appropriate Use of Suspension and Expulsion

Except when a student commits an act that violates Education Code 48900(a)-(e), as listed in items #1-5 under "Grounds for Suspension and Expulsion: Grades K-12 of the accompanying regulation, or when the student's presence causes a danger to others, suspension shall be used only when other means of correction have failed to bring about proper conduct. (Education Code 48900.5, 48900.6)

(cf. 5138 – Conflict Resolution/Peer Mediation)

(cf. 5144 – Discipline)

(cf. 6142.4 – Service Learning/Community Service Classes)

(cf. 6164.2 – Guidance/Counseling Services)

(cf. 6164.5 – Student Success Teams)

A student's parents/guardians shall be notified as soon as possible when there is an escalating pattern of misbehavior that could lead to classroom or school removal.

No student in grades K-8 may be suspended for disruption or willful defiance, except by a teacher pursuant to Education Code 48910. (Education Code 48900)

Students shall not be suspended or expelled for truancy, tardiness, or absenteeism from assigned school activities.

(cf. 5113 – Absences and Excuses)

(cf. 5113.1 – Chronic Absence and Truancy)

On Campus Suspension

To ensure the proper supervision and ongoing learning of students who are suspended for any of the reasons enumerated in Education Code 48900 and 48900.2, but who pose no imminent danger or threat to anyone at school and for whom expulsion proceedings have not been initiated, the Superintendent or designee shall establish a supervised suspension classroom program which meets the requirements of law.

Except where a supervised suspension is permitted by law for a student’s first offense, supervised suspension shall be imposed only when other means of correction have failed to bring about proper conduct. (Education Code 48900.5)

Authority to Expel

A student may be expelled only by the Board. (Education Code 48918(j))

As required by law, the Superintendent or principal shall recommend expulsion and the Board shall expel any student found to have committed any of the following “mandatory recommendation and mandatory expulsion: acts at school or at a school activity off school grounds: (Education Code 48915)

Possessing a firearm which is not an imitation firearm, as verified by a certificated employee, unless the student had obtained prior written permission to possess the item from a certificated school employee, with the principal or designee’s concurrence

(cf. 5131.7 – Weapons and Dangerous Instruments)

1. Selling or otherwise furnishing a firearm
2. Brandishing a knife at another person
3. Unlawfully selling a controlled substance listed in Health and Safety Code 11053-11058
4. Committing or attempting to commit a sexual assault as defined in Penal Code 261, 266c, 286, 288, 288a, or 289 or committing a sexual battery as defined in Penal Code 243.4
5. Possessing an explosive as defined in 18 USC 921

For all other violations listed in the accompanying administrative regulation, the Superintendent or principal shall have discretion to recommend expulsion of a student. If expulsion is recommended, the Board shall order the student expelled only if it makes a finding of either or both of the following: (Education Code 48915(b) and (e))

1. That other means of correction are not feasible or have repeatedly failed to bring about proper conduct
2. That due to the nature of the violation, the presence of the student causes a continuing danger to the physical safety of the student or others

A vote to expel a student shall be taken in an open session of a Board meeting.

The Board may vote to suspend the enforcement of the expulsion order pursuant to the requirements of law and the accompanying administrative regulation. (Education Code 48917)

No student shall be expelled for disruption or willful defiance. (Education Code 48900)

No child enrolled in a preschool program shall be expelled except under limited circumstances as specified in AR 5148.3 – Preschool/Early Childhood Education.

(cf. 5148.3 – Preschool/Early Childhood Education)

Due Process

The Board shall provide for the fair and equitable treatment of students facing suspension and expulsion by affording them their due process rights under the law. The Superintendent or designee shall comply with procedures for notices, hearings, and appeals as specified in law and administrative regulation. (Education Code 48911, 48915, 48915.5, 48918)

(cf. 5119 - Students Expelled from Other Districts)

(cf. 5144.2 - Suspension and Expulsion/Due Process (Students with Disabilities))

Maintenance and Monitoring of Outcome Data

The Superintendent or designee shall maintain outcome data related to student suspensions and expulsions in accordance Education Code 48900.8 and 48916.1, including, but not limited to, the number of students recommended for expulsion, the grounds for each recommended expulsion, the actions taken by the Board, the types of referral made after each expulsion, and the disposition of the students after the expulsion period. For any expulsion that involves the possession of a firearm, such data shall include the name of the school and the type of firearm involved, as required pursuant to 20 USC 7961. Suspension and expulsion data shall be reported to the Board annually and to the California Department of Education when so required.

In presenting the report to the Board, the Superintendent or designee shall disaggregate data on suspensions and expulsions by school and by numerically significant student subgroups, including, but not limited to, ethnic subgroups, socioeconomically disadvantaged students, English learners, students with disabilities, foster youth, and homeless students. Based on the data, the Board shall address any identified disparities in the imposition of student discipline and shall determine whether and how the district is meeting its goals for improving school climate as specified in its local control and accountability plan.

(cf. 0460 - Local Control and Accountability Plan)

Adoption Date: 6/28/1983,

Amended:12/13/1983;08/13/1986;02/18/1988;02/15/1990;09/19/1991;08/15/1996;05/16/2002;08/18/2005;08/20/2009;
08/20/2012; 09/18/2014; 04/11/2019; 05/21/2020

Students

Nondiscrimination/Harassment

This policy shall apply to all acts constituting unlawful discrimination or harassment related to school activity or to school attendance occurring within district school and to acts which occur off campus or outside of school-related or school-sponsored activities but which may have an impact or create a hostile environment at school.

The Governing Board desires to provide a safe school environment that allows all students equal access and opportunities in the District's academic, extracurricular, and other educational support programs, services, and activities. The Board prohibits, at any District school or school activity, unlawful discrimination, including discriminatory harassment, intimidation, and bullying, targeted at any student by anyone, based on the student's actual or perceived race, color, ancestry, nationality, national origin, immigration status, ethnic group identification, ethnicity, age, religion, marital status, pregnancy, parental status, physical or mental disability, medical condition, sex, sexual orientation, gender, gender identity, gender expression, or genetic information, or association with a person or group with one or more of these actual or perceived characteristics.

(cf. 0410 - Nondiscrimination in District Programs and Activities)

(cf. 5131 - Conduct)

(cf. 5131.2 - Bullying)

(cf. 5137 - Positive School Climate)

(cf. 5145.7 – Sexual Harassment)

(cf. 5145.9 - Hate-Motivated Behavior)

(cf. 5146 - Married/Pregnant/Parenting Students)

(cf. 6164.6 - Identification and Education Under Section 504)

Unlawful discrimination, including discriminatory harassment, intimidation, or bullying, may result from physical, verbal, nonverbal, or written conduct based on any of the categories listed above. Unlawful discrimination also occurs when prohibited conduct that is so severe, persistent, or pervasive that it affects a student's ability to participate in or benefit from an educational program or activity; creates an intimidating, threatening, hostile, or offensive educational environment; has the effect of substantially or unreasonably interfering with a student's academic performance; or otherwise adversely affects a student's educational opportunities.

Unlawful discrimination also includes disparate treatment of students based on one of the categories above with respect to the provision of opportunities to participate in school programs or activities or the provision or receipt of educational benefits or services.

The Board also prohibits any form of retaliation against any individual who reports or participates in the reporting of unlawful discrimination, files or participates in the filing of a complaint, or investigates or participates in the investigation of a complaint or report alleging unlawful discrimination. Retaliation complaints shall be investigated and resolved in the same manner as a discrimination complaint.

The Superintendent or designee shall facilitate students' access to the educational program by publicizing the District's nondiscrimination policy and related complaint procedures to students, parents/guardians, and employees. In addition, the Superintendent or designee shall post the district's policies prohibiting discrimination, harassment intimidation, and bullying and other required information on the district's web site in a manner that is easily accessible to parents/guardians and students, in accordance with law and accompanying administrative regulation.

The Superintendent or designee shall provide training and/or information on the scope and use of the policy and complaint Comprehensive School Safety Plan

procedures and take other measures designed to increase the school community's understanding of the requirements of law related to discrimination. The Superintendent or designee shall regularly review the implementation of the district's nondiscrimination policies and practices and, as necessary, shall take action to remove any identified barrier to student access to or participation in the district's educational program. The Superintendent or designee shall report the findings and recommendations to the Board after each review.

Comprehensive School Safety Plan

(cf. 1312.3 - Uniform Complaint Procedures)

(cf. 1330 - Use of Facilities)

(cf. 4131/4231/4331 - Staff Development)

(cf. 6145 - Extracurricular and Co-Curricular Activities)

(cf. 6145.2 - Athletic Competition)

(cf. 6164.2 - Guidance/Counseling Services)

Regardless of whether a complainant complies with the writing, timeline, and/or other formal filing requirements, all complaints alleging unlawful discrimination, including discriminatory harassment, intimidation, or bullying, shall be investigated and prompt action taken to stop the discrimination, prevent recurrence, and address any continuing effect on students.

Students who engage in unlawful discrimination, including discriminatory harassment, intimidation, retaliation, or bullying, in violation of law, Board policy, or administrative regulation shall be subject to appropriate consequence or discipline, which may include suspension or expulsion when the behavior is severe or pervasive as defined in Education Code 48900.4. Any employee who permits or engages in prohibited discrimination, including discriminatory harassment, intimidation, retaliation, or bullying, shall be subject to disciplinary action, up to and including dismissal.

(cf. 4118 – Dismissal/Suspension/Disciplinary Action)

(cf. 4119.21/4219.21/4319.21 - Professional Standards)

(cf. 4218 - Dismissal/Suspension/Disciplinary Action)

(cf. 5144 - Discipline)

(cf. 5144.1 - Suspension and Expulsion/Due Process)

(cf. 5144.2 - Suspension and Expulsion/Due Process (Students with Disabilities))

(cf. 5145.2 - Freedom of Speech/Expression)

Recordkeeping

The Superintendent or designee shall maintain a record of all reported cases of unlawful discrimination, including discriminatory harassment, intimidation, or bullying, to enable the district to monitor, address, and prevent repetitive prohibited behavior in District schools.

Policy adopted: 06/28/1983

Renumbered: 08/13/1986

Amended: 11/27/1984; 07/20/1995; 04/13/2000; 05/16/2002; 07/15/2004; 08/16/2012; 09/18/2014; 11/19/2015; 02/18/2016; 11/17/2016; 09/20/2018; 10/15/2020

Emergency Evacuation Map(s)

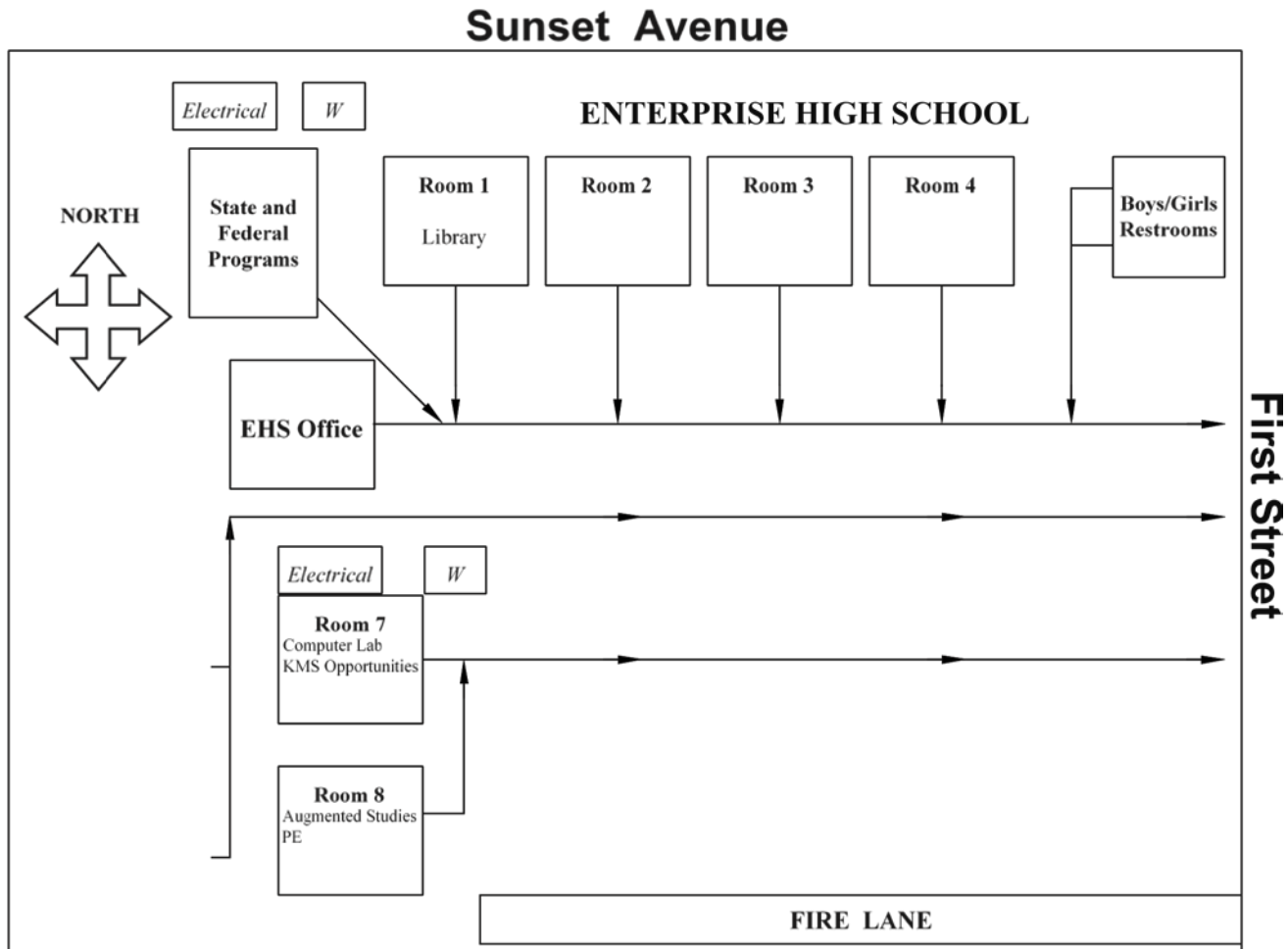

W = Water Shut Off
 Electrical = Electrical Shut Off

FIRE LANE = Fire Truck Access to Campus